



[Residents Alliance Group](#) November 2023

## Contents

[What's Happening on the Site](#)

[Family Accommodation Unit](#)

[CRIC](#)

[Linear Park](#)

[BAM Community Fund](#)

[Traffic Management Workshop](#)

## What's Happening on the Site

“Work on site continues at a pace which should see the much-awaited completion arrive in the first quarter of 2024.”

*NCH Bulletin March 2023*

.....Well that NCH March completion date was incorrect.



Current estimated completion date is October 2024, that is when the contractor hands the site over to CHI and then there is at least a 6 month “commissioning” of equipment, services etc so in terms of the NCH opening to the public it could be mid 2025 .

- [Joint Oireachtas Committee on Health Wednesday 12<sup>th</sup> July 2023 Opening Statement](#)
- [Committee of Public Accounts debate Oct 2023](#)

In the meantime work continues;

- Internal campus road now and round about has become operational.
- MountBrown/Cameron Sq steps operational with temporary handrail and lights to be replaced in coming fortnight. Hoarding to remain on site side until job is finished.
- MACE junction kerbing installed but civil work ongoing. Work due to finish after Christmas as Operation Freeflow comes into operation .
- At the MACE junction the left filter green traffic light was to be reinstated however DCC who manage the traffic configuration are unsure as this point.
- All concrete works on site are now finished bar some soft landscaping
- Inside building the south fingers are being commissioned (furnishings, mirrors door handles)
- Concourse; removing scaffolding for underfloor heating and tiling.
- Ward blocks significantly advanced.
- Heli pad will be commissioned some time next year, the process is a CHI Aviation Authority process.

## Family Accommodation Unit

The site for Family Accommodation Unit has been returned to NPHDB from BAM . A preferred bidder to be agreed by end of November (not BAM) and to commence build in February2024.( 9 month build)

## CRIC Building

No dates agreed for the CRIC Building, although subject to 2016 planning permission that is legal for 10 years. The building is to be funded by Philanthropic donations and this process is managed by CHI.

## Cameron Steps



Figure 1 Existing steps

People have welcomed the major refurbishment of current steps at Cameron Sq Mount Brown. Temporary lighting and balustrades are in place pending the final upgrade in coming weeks.

The hoarding will remain on the hospital side until the work is complete but residents welcome the upgrade that brings the steps into safe public use again.



Figure 2 New Steps almost complete Nov 23

On going works at

- MACE Junction
- Mount Brown Entrance

For details see [Residents Alliance Group website](#)

If residents have any questions, please contact BAM site security manager Derek at any time on 087 6967723, or email ChloeMcHugh to at [cmchugh@bam.com](mailto:cmchugh@bam.com).

[back](#)

## Traffic Management Workshop

The Resident's Monitoring Committee are planning a follow up Workshop to the one held earlier this year.

The planning for the event will take place in early December and the event itself will take place in early February.

The workshop is similar to the previous one and will be co hosted by the James's Campus with Dublin City Council Traffic Management as the keynote speaker.

The issues facing the area are complex, between sustainable transports policy commitments and the increased vehicular traffic, the ever expanding developments adjacent to the hospital campus and the ambitious planned expansion of the complex into the future poses serious questions for planners, residents and service users in and around St James's.

Issues include

- MACE Turn /Filter

- James CRIC and adjacent developments
- Additional James's Planned development
- CSO data
- Parking
- Cycle ways
- BUS corridor

For more see: RAG website [TRAFFIC](#)

[Draft Dublin City Centre Transport Plan 2023.pdf](#)

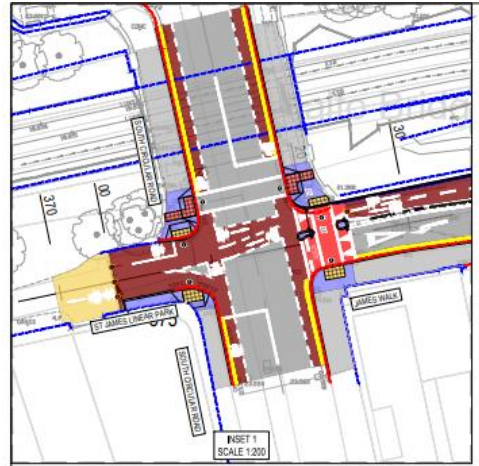

Figure 3 Rialto Bridge reconfiguration

[back](#)

**Suir Road Junction Upgrade** It is expected that this phase will be implemented in Q1/Q2 2024.

### Cycle Way Suir Road to Thomas St (Interim Scheme)

Link to between Marrowbone Lane to Thomas Street. It is expected that this phase will be implemented in Q1/Q2 2024.

The Kilmainham to Thomas Street Active Travel Project is part of the Dublin City Council (DCC) core active travel network and it will provide 2.6km of high quality walking and cycling facilities from South Circular Road /Kilmainham Lane junction to the Thomas Court to the junction with Thomas Street.

Kilmainham to Thomas St (Permanent measures)

The interim scheme is projected to be completed in Q1 2024.

The project is being delivered on a phased basis.

Public Consultation for the permanent design is planned for Q2 2024.

James Walk, Marrowbone Lane, Forbes Lane and Rialto Bridge.

For more information on the phasing approach, follow the Project Overview and Design Information link below.

[Kilmainham to Thomas Street - Project Page](#)

Commenced installation of this first phase in August, 2023. The implementation of this phase is ongoing and it is expected to be substantially complete by Dec 2023.

To receive email updates about the Kilmainham to Thomas Street Project.

<https://alerts.dublincity.ie/activetravel-public>

[Suir Road to Thomas St Eng Accessible Singles 0.pdf \(dublincity.ie\)](#)



Two way protected cycle track on the North side of James Walk

[back](#)

## Pedestrian access to Rialto Luas Stop

The planned closure of the pedestrian access to the Luas stop at Rialto bridge has been held up for some time due to the alternative route not being available.

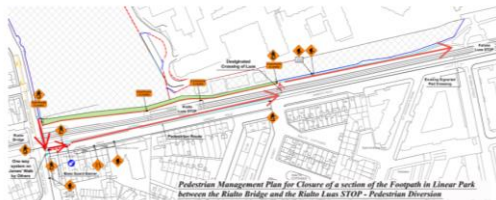

The closure will occur and BAM will notify public of dates when available..

## Linear Park

DDC Parks Services reinstatement of the Linear Park begins to take form at the Basin Street end with two amenities developed as a result of the consultative process with residents in 2018.

## Playground

The Basin End park has been in operation for some months and is viewed as a significant addition to the area both as an amenity and as a deterrent to anti social behaviour by encouraging adults to stop and use the amenities.

## Community Garden



The EdibleOpen Community Garden located around the old walls is an experiment in a shared, open growing space in the city. It was planted by over 30 local residents with design and guidance from Suzie Cahn from [Dulra](#)

[Permaculture Garden](#). To date DCC has hosted workshops with Suzie and Suzie will run a few workshops next year.

*"Please don't hesitate to take ownership and make the most of the opportunity to grow at any time. You are encouraged to take cuttings, harvest some of the produce, and contribute by planting in any available gaps. Your active involvement will help this corner of the park flourish!"*

[Edimental Community Garden at the Linear Park at St James Suzanne O'Connell of Dublin City Council Parks Services talks about the new emerging grow... | By The Liberties Dublin | Facebook](#)

[back](#)

## BAM COMMUNITY FUND

The BAM Community Fund is still operational and application guidelines are currently being finalised and details will be published in January 2024

## Questions and Answers

If you have any questions or issues you want raised with the NCH or the contractors in relation to the build please forward them to the e-mail address below and we will raise them at the next [Residents Monitoring Committee](#) meeting .